



ISO 9001:2008 Certified

## PIONEER ENTERPRISE

101, Raudat Tahera Street, Mumbai - 400 003, India.

Tel : (91-22) 2347 2534 Telefax : (91-22) 2347 0325

E-mail: [pionlace@vsnl.com](mailto:pionlace@vsnl.com), [pioneerfitting@yahoo.com](mailto:pioneerfitting@yahoo.com)

Website: [www.instrumentation-fittings.com](http://www.instrumentation-fittings.com)

### Lined Diaphragm Valve

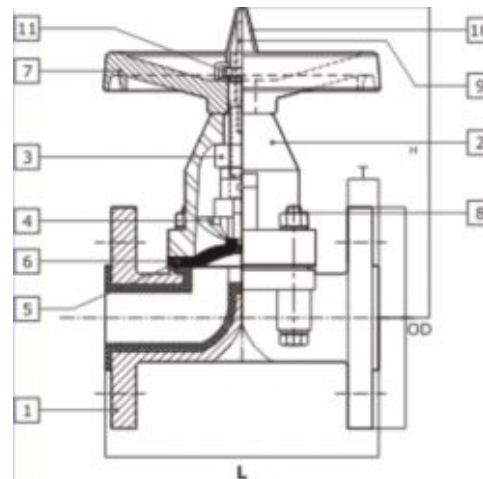

#### Dimension Table

Size (NB)	L ± 3	OD	T	H
25 MM	133	108	15	142
40 MM	166	127	17	160
50 MM	196	152	20	200
65 MM	222	178	22	250
80 MM	260	191	23	280
100 MM	311	230	23	350
150 MM	412	280	25	510

#### Material Specification

NO.	DESCRIPTION	QTY.	MATERIAL
1	BODY	1	CS / SS + PPH/PVDF / FEP / PFA
			LINED LINING: 3mm THK.
2	BONNET	1	GRADED CAST IRON
3	SLEEVE & SPINDLE	1	SS-304 / SS-410
4	COMPRESSOR	1	ASTM A 216 GR WCB
5	DIAPHRAGM	1	PTFE
6	RUBBER PAD	1	EPDM
7	HAND WHEEL	1	CAST IRON
8	FASTENERS	-	SS-304 / STEEL PLATED
9	POSITION INDICATOR	1	PP/PVC
10	INDICATOR CAP	1	POLYCARBONATE
11	HANDWHEEL NUT	1	STEEL PLATED

#### Notes:

Manufacturing Standards

Design : EN 1337 : 2002 BS 5156

Face To Face Dimension : EN 558-1 Series 7 & 1

Spark Test

15 KVDC

Standard Resin Specifications For Lining

PTFE : ASTM D 1457

PVDF : ASTM D 3222

PFA : ASTM D 3418

FEP : ASTM D 2116

Material

CS : ASTM A 216 GR. WCB

SS : ASTM A 351 CF B/ ASTM A 351 CFB M



ISO 9001:2008 Certified

## PIONEER ENTERPRISE

101, Raudat Tahera Street, Mumbai - 400 003, India.

Tel : (91-22) 2347 2534 Telefax : (91-22) 2347 0325

E-mail: [pionlace@vsnl.com](mailto:pionlace@vsnl.com), [pioneerfitting@yahoo.com](mailto:pioneerfitting@yahoo.com)

Website: [www.instrumentation-fittings.com](http://www.instrumentation-fittings.com)

### Lined Ball Valve

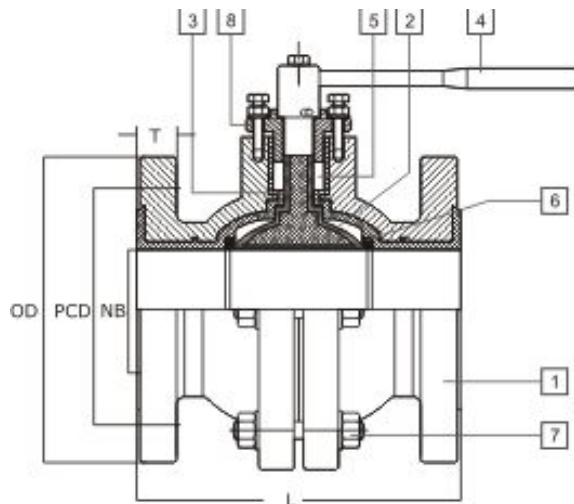

Dimension Table

Size (NB)	L ± 3	OD	T
15 MM	108	89	14
20 MM	118	98	14
25 MM	127	108	17
40 MM	165	127	17
50 MM	178	152	19
80 MM	103	191	23
100 MM	119	119	13
150 MM	267	280	25

Material Specification

NO.	DESCRIPTION	QTY.	MATERIAL
1	BODY	2	CS / SS + PPH/PVDF / FEP / PFA
			LINED LINING: 3mm THK.
2	BALL	1	CS/SS + PPH/PVDF/PFA/FEP LINED
3	STEM	1	CS / SS + PPH/PVDF / FEP / PFA
			LINED INTERNAL PART OF BALL
4	HANDLE	1	MS EPOXY PAINTED
5	GRAND SEAL	1	PTFE
6	SEAT	2	PTFE
7	FASTENERS	-	SS-304 / STEEL PLATED
8	GLAND COVER	1	CS/SS EPOXY PAINTED

#### Notes:

##### Manufacturing Standards

Design : BS 5351 - Short Pattern  
 Face To Face Dimension : ANSI B 16.10  
 Range Connection : ANSI B 16.5; 150 RF  
 Test Standard : ISO 9393-2/API 598/  
 BS EN 12266-1:2003

Spark Test  
 15 KVDC

##### Standard Resin Specifications for Lining

PTFE : ASTM D 1457  
 PVDF : ASTM D 3222  
 PFA : ASTM D 3418  
 FEP : ASTM D 2116

##### Material

CS : ASTM A 216 GR. WCB  
 SS : ASTM A 351 CF B/ ASTM A 351 CFB M



**Pioneer Enterprise**

ISO 9001:2008 Certified

## PIONEER ENTERPRISE

101, Raudat Tahera Street, Mumbai - 400 003, India.

Tel : (91-22) 2347 2534 Telefax : (91-22) 2347 0325

E-mail: [pionlace@vsnl.com](mailto:pionlace@vsnl.com), [pioneerfitting@yahoo.com](mailto:pioneerfitting@yahoo.com)

Website: [www.instrumentation-fittings.com](http://www.instrumentation-fittings.com)

### Lined Butterfly Valve Lever Operated

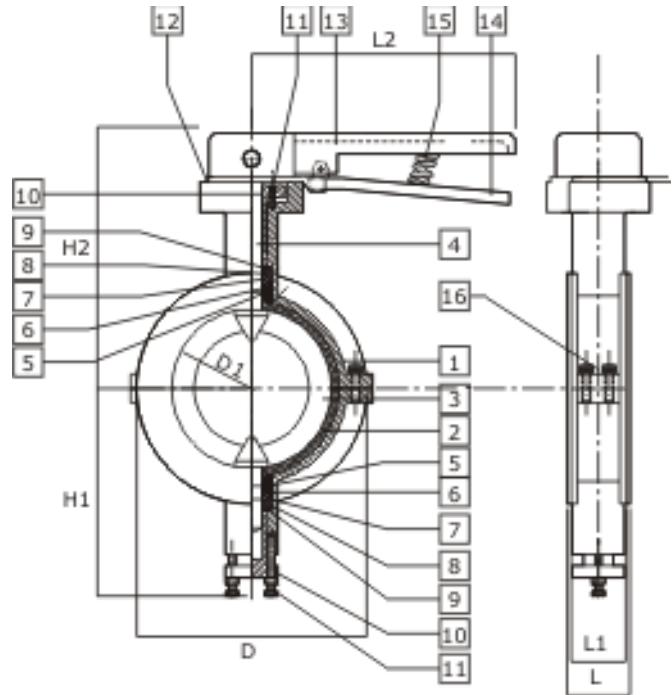

Dimension Table

Size (NB)	$L \pm 3$	$L1 \pm 1$	$D1 \pm 2$	$D \pm 2$	$H1 \pm 8$	$H2 \pm 8$	$L2 \pm 8$
50 MM	51	43	50	92	122	148	260
65 MM	54	46	65	105	132	162	260
80 MM	54	46	75	127	140	170	260
100 MM	60	52	100	157	150	192	260

## Material Specification

NO.	DESCRIPTION	QTY.	MATERIAL
1	BODY	2	CS / SS EPROXY PAINTED
2	SEAT	1	PTFE
3	DISC	1	SS INSERTED PPH/PVDF/PFA/FEP LINED
4	STEM	1	SS 304 INTEGRAL TO DISC
5	STEM SEAL-TOP & BOTTOM	2	PTFE
6	SEAL CUP-TOP & BOTTOM	2	PPH/PVDF/PFA/FEP
7	TEE BRUSH -TOP & BOTTOM	1	SS 304
8	DISC SPRING-TOP & BOTTOM	2	50 Crv
9	THRUST WASHER-TOP & BOTTOM	2	SS 304
10	THRUST COLLAR-TOP & BOTTOM	2	STEEL / SS
11	ADJUSTABLE BOLTS	1	SS / STEEL PLATED
12	POSITIONER LOCK PLATE	1	STEEL PLATED
13	HANDLE LEVER	1	STEEL POWDER COATED
14	POSITIONER LEVER	1	STEEL POWDER COATED
15	SPRING	1	SPRING STEEL POWDER COATED
16	FASTENERS	1	H.T. STEEL / SS

### Notes:

#### Manufacturing Standards

Design : API 609 - Wafer Type  
 Face To Face Dimension : API 609 Category 'A'  
 Range Connection : ANSI B 16.5; 150 RF  
 Test Standard : ISO 9393-2/API 598/BS EN 12266-1:2003

#### Spark Test

15 KVDC

#### Standard Resin Specifications For Lining

PTFE : ASTM D 1457  
 PVDF : ASTM D 3222  
 PFA : ASTM D 3418  
 FEP : ASTM D 2116

#### Material

CS : ASTM A 216 GR. WCB  
 SS : ASTM A 351 CF B/ ASTM A 351 CFB M



**Pioneer Enterprise**

ISO 9001:2008 Certified

## PIONEER ENTERPRISE

101, Raudat Tahera Street, Mumbai - 400 003, India.

Tel : (91-22) 2347 2534 Telefax : (91-22) 2347 0325

E-mail: [pionlace@vsnl.com](mailto:pionlace@vsnl.com), [pioneerfitting@yahoo.com](mailto:pioneerfitting@yahoo.com)

Website: [www.instrumentation-fittings.com](http://www.instrumentation-fittings.com)

### Lined Butterfly Valve Gear Operated

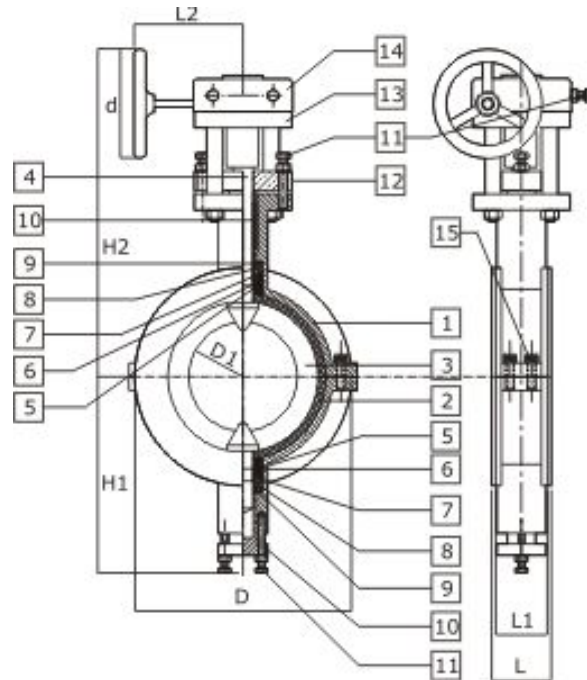

Dimension Table

Size (NB)	$L \pm 3$	$L1 \pm 1$	$D1 \pm 2$	$D \pm 2$	$H1 \pm 8$	$H2 \pm 8$	$L2 \pm 8$	$d \pm 8$
125 MM	64	56	125	185	165	390	242	250
150 MM	64	56	150	216	190	425	242	250
200 MM	70	60	200	270	200	465	242	250
250 MM	80	68	250	323	250	550	285	350
300 MM	90	78	300	380	295	620	285	350
350 MM	90	78	350	412	335	655	285	350
400 MM	114	102	400	470	365	685	285	350

## Material Specification

No.	DESCRIPTION	Qty.	MATERIAL
1	BODY	2	CS / SS EPROXY PAINTED
2	SEAT	1	PTFE
3	DISC	1	SS INSERTED PPH/PVDF/PFA/FEP LINED
4	STEM	1	SS 304 INTEGRAL TO DISC
5	STEM SEAL-TOP & BOTTOM	2	PTFE
6	SEAL CUP-TOP & BOTTOM	2	PPH/PVDF/PFA/FEP
7	TEE BRUSH -TOP & BOTTOM	1	SS 304
8	DISC SPRING-TOP & BOTTOM	2	50 Crv
9	THRUST WASHER-TOP & BOTTOM	2	SS 304
10	THRUST COLLAR-TOP & BOTTOM	2	STEEL / SS
11	ADJUSTABLE BOLTS	1	SS / STEEL PLATED
12	POSITIONER LOCK PLATE	1	STEEL PLATED
13	HANDLE LEVER	1	STEEL POWDER COATED
14	POSITIONER LEVER	1	STEEL POWDER COATED
15	SPRING	1	SPRING STEEL POWDER COATED
16	FASTENERS	1	H.T. STEEL / SS

### Notes:

#### Manufacturing Standards

Design : API 609 - Wafer Type  
 Face To Face Dimension : API 609 Category 'A'  
 Range Connection : ANSI B 16.5; 150 RF  
 Test Standard : ISO 9393-2/API 598/BS EN 12266-1:2003

#### Spark Test

15 KVDC

#### Standard Resin Specifications For Lining

PTFE : ASTM D 1457  
 PVDF : ASTM D 3222  
 PFA : ASTM D 3418  
 FEP : ASTM D 2116

#### Material

CS : ASTM A 216 GR. WCB  
 SS : ASTM A 351 CF B/ ASTM A 351 CFB M



ISO 9001:2008 Certified

## PIONEER ENTERPRISE

101, Raudat Tahera Street, Mumbai - 400 003, India.

Tel : (91-22) 2347 2534 Telefax : (91-22) 2347 0325

E-mail: [pioneer@vsnl.com](mailto:pioneer@vsnl.com), [pioneerfitting@yahoo.com](mailto:pioneerfitting@yahoo.com)

Website: [www.instrumentation-fittings.com](http://www.instrumentation-fittings.com)

### Lined Ball Check Valve

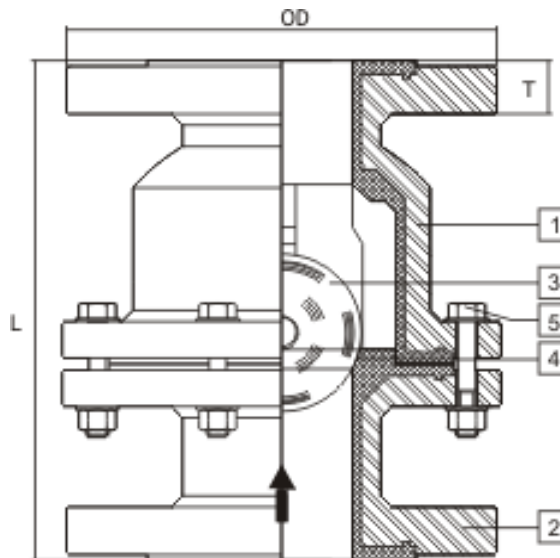

#### Dimension Table

Size (NB)	L ± 3	OD	T
25 MM	127	108	17
40 MM	165	127	17
50 MM	178	152	19
80 MM	203	191	23
100 MM	229	230	23
150 MM	303	280	25
200 MM	425	343	28

#### Material Specification

NO.	DESCRIPTION	QTY.	MATERIAL
1	BODY	1	CS / SS +3 mm THK. PPH/PVDF/FEP/PFA LINING.
2	END PIECE	1	CS / SS +3 mm THK. PPH/PVDF/FEP/PFA LINING.
3	BALL	1	SOLID PTFE
4	STEM	1	INTEGRAL PVDF/FEP/PFA
5	FASTENERS	1	SS- 304/ STEEL PLATED

#### Notes:

Manufacturing Standards

Design : Manufacturer's Standard  
 Face To Face Dimension : ANSI B 16 upto 100NB size, above 100NB size, Manufacturer's Standard.

Spark Test  
 15 KVDC

Standard Resin Specifications For Lining

PTFE : ASTM D 1457  
 PVDF : ASTM D 3222  
 PFA : ASTM D 3418  
 FEP : ASTM D 2116

Material

CS : ASTM A 216 GR. WCB  
 SS : ASTM A 351 CF B/ ASTM A 351 CFB M



ISO 9001:2008 Certified

## PIONEER ENTERPRISE

101, Raudat Tahera Street, Mumbai - 400 003, India.

Tel : (91-22) 2347 2534 Telefax : (91-22) 2347 0325

E-mail: [pionlace@vsnl.com](mailto:pionlace@vsnl.com), [pioneerfitting@yahoo.com](mailto:pioneerfitting@yahoo.com)

Website: [www.instrumentation-fittings.com](http://www.instrumentation-fittings.com)

### Lined Swing Check Valve

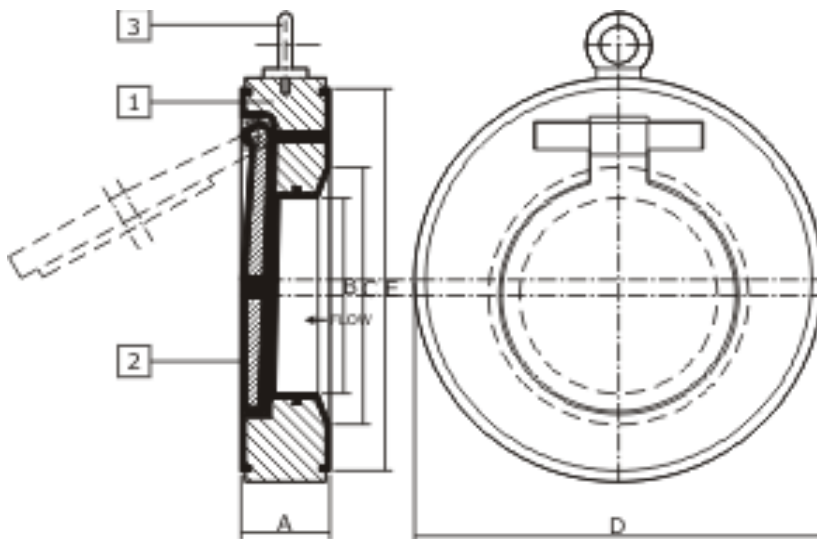

Dimension Table

Size (NB)	A±3	B	C	D	E
80 MM	38	44	60	132	127
100 MM	52	65	80	171	152
150 MM	56	111	128	217	207
200 MM	60	133	175	274	260
250 MM	68	184	224	335	317
300 MM	78	232	272	405	377
350 MM	88	245	285	445	410

Material Specification

NO.	DESCRIPTION	QTY.	MATERIAL
1	BODY	1	CS / SS +3 mm THK. PPH/PVDF/FEP/PFA LINING.
2	FLAP	1	CS / SS +3 mm THK. PPH/PVDF/FEP/PFA LINING.
3	EYE HOOK	1	STEEL PLATED

#### Notes:

##### Manufacturing Standards

Design : Manufacturer's Standard  
Face To Face Dimension : Manufacturer's Standard.

##### Material

CS : ASTM A 216 GR. WCB  
SS : ASTM A 351 CF B/ ASTM A 351 CFB M

##### Spark Test

15 KVDC

##### Standard Resin Specifications For Lining

PTFE : ASTM D 1457  
PVDF : ASTM D 3222  
PFA : ASTM D 3418  
FEP : ASTM D 2116



ISO 9001:2008 Certified

## PIONEER ENTERPRISE

101, Raudat Tahera Street, Mumbai - 400 003, India.

Tel : (91-22) 2347 2534 Telefax : (91-22) 2347 0325

E-mail: [pionlace@vsnl.com](mailto:pionlace@vsnl.com), [pioneerfitting@yahoo.com](mailto:pioneerfitting@yahoo.com)

Website: [www.instrumentation-fittings.com](http://www.instrumentation-fittings.com)

### Lined 'Y' Type Strainer

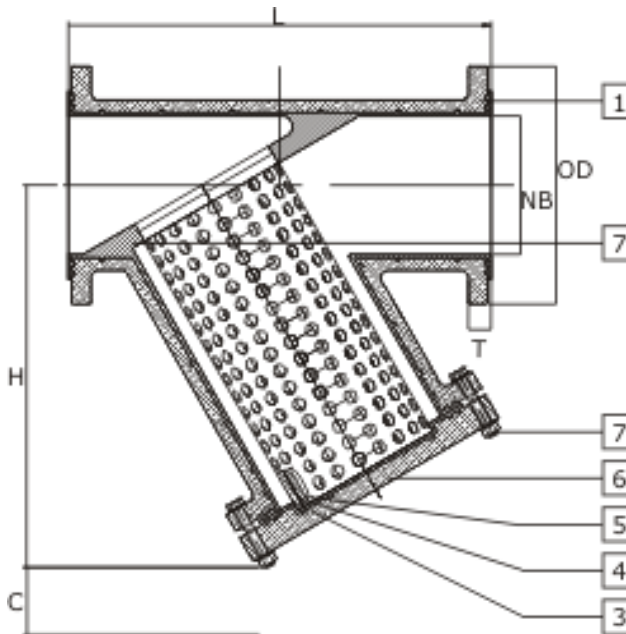

Dimension Table

Size (NB)	L ± 5	OD	H	T
25 MM	190	108	128	17
40 MM	265	127	240	17
50 MM	290	153	210	19
65 MM	320	178	240	22
80 MM	350	191	250	23
100 MM	415	230	310	23
150 MM	520	280	388	25
200 MM	605	343	585	26

Material Specification

NO.	DESCRIPTION	QTY.	MATERIAL
1	SHELL	1	CS / SS +3 mm THK. PPH/PVDF/FEP/PFA LINING.
2	SEAT	1	INTERGRAL PVDF/FEP/PFA
3	OUTER TUBE	1	PTFE
4	FILTER TUBE	1	ETFE-MESH SIZE 40
5	INNER TUBE	1	PTFE
6	SHELL COVER	1	CI / DI + PVDF/FEP/PFA LINING.
7	FASTENERS	-	SS / STEEL PLATED

#### Notes:

Manufacturing Standards

Design : Manufacturer's Standard

Face To Face Dimension : Manufacturer's Standard.

Spark Test  
15 KVDC

#### Standard Resin Specifications For Lining

PTFE : ASTM D 1457

PVDF : ASTM D 3222

PFA : ASTM D 3418

FEP : ASTM D 2116

#### Material

DI : ASTM A 395

CI : GRADED CASTING



ISO 9001:2008 Certified

## PIONEER ENTERPRISE

101, Raudat Tahera Street, Mumbai - 400 003, India.

Tel : (91-22) 2347 2534 Telefax : (91-22) 2347 0325

E-mail: [pionlace@vsnl.com](mailto:pionlace@vsnl.com), [pioneerfitting@yahoo.com](mailto:pioneerfitting@yahoo.com)

Website: [www.instrumentation-fittings.com](http://www.instrumentation-fittings.com)

### Lined Sight Glass Full Type View

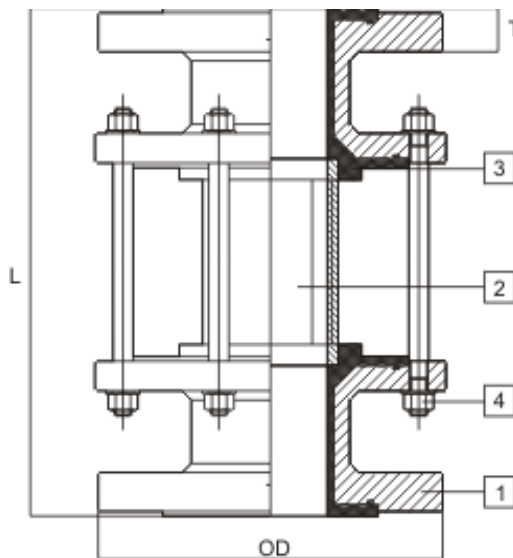

#### Dimension Table

Size (NB)	L ± 3	OD	T
25 MM	162	108	17
40 MM	180	127	17
50 MM	212	153	19
80 MM	258	191	23
100 MM	298	230	23
150 MM	375	280	29

#### Material Specification

NO.	DESCRIPTION	QTY.	MATERIAL
1	END PIECE	2	CS / SS +3 mm THK. PPH/PVDF/FEP/PFA LINING.
2	GLASS TUBE	1	BOROSIL
3	SEAT	2	INTEGRAL PPH/PVDF/FEP/PFA
4	FASTENERS	-	SS-304/STEEL PLATED

#### Notes:

Manufacturing Standards

Design : Manufacturer's Standard

Face To Face Dimension : Manufacturer's Standard.

Spark Test

15 KVDC

Standard Resin Specifications For Lining

PVDF : ASTM D 3222

PFA : ASTM D 3418

FEP : ASTM D 2116

Material

CS : ASTM A 216 GR. WCB

SS : ASTM A 351 CF B/ ASTM A 351 CFB M



ISO 9001:2008 Certified

## PIONEER ENTERPRISE

101, Raudat Tahera Street, Mumbai - 400 003, India.

Tel : (91-22) 2347 2534 Telefax : (91-22) 2347 0325

E-mail: [pionlace@vsnl.com](mailto:pionlace@vsnl.com), [pioneerfitting@yahoo.com](mailto:pioneerfitting@yahoo.com)

Website: [www.instrumentation-fittings.com](http://www.instrumentation-fittings.com)

### Lined Double Window Sight Glass

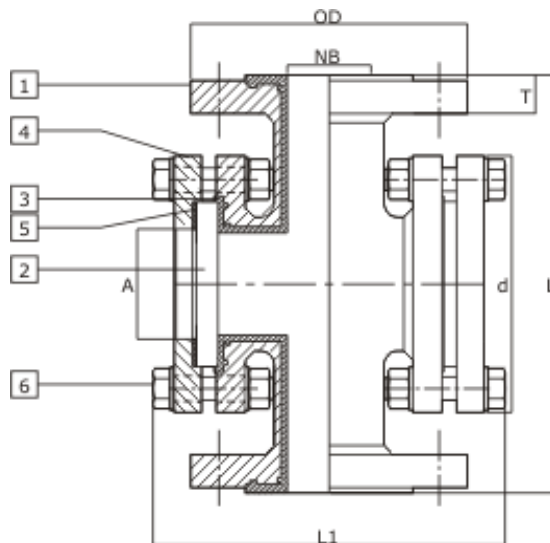

Dimension Table

Size (NB)	L ± 3	OD	T	L1	d	A
25 MM	178	108	17	130	85	30
40 MM	204	127	17	150	110	45
50 MM	228	152	19	170	135	60
65 MM	254	178	20	200	155	75
80 MM	280	191	23	220	175	90
100 MM	330	228	23	260	205	110
125 MM	380	254	25	290	225	135
150 MM	406	280	25	340	250	175
200 MM	458	343	28	400	315	225

Material Specification

NO.	DESCRIPTION	QTY.	MATERIAL
1	END PIECE	1	CS / SS +3 mm THK. PPH/PVDF/FEP/PFA LINING.
2	GLASS	2	TOUGHENED BOROSIL
3	SEAT	2	INTEGRAL PPH/PVDF/FEP/PFA
4	COVER FLANGE	2	CS / SS
5	GLASS PACKING	2	PTFE
6	FASTENERS	-	SS-304/STEEL PLATED

#### Notes:

Manufacturing Standards

Design : Manufacturer's Standard  
Face To Face Dimension : Manufacturer's Standard.

Spark Test  
15 KVDC

Standard Resin Specifications For Lining

PVDF : ASTM D 3222  
PFA : ASTM D 3418  
FEP : ASTM D 2116

Material

CS : ASTM A 216 GR. WCB  
SS : ASTM A 351 CF B/ ASTM A 351 CFB M